

Note

For pilot diameter, match pilot shank size, from style #884 or #879, to pilot shank size S_1 in these columns.

ANSI
SIZES

HSS

Surface
Treatment

Bright

Counterbore

High Speed Steel

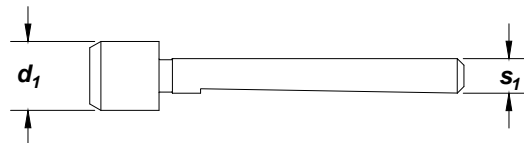

pilot diameter d_1	decimal equiv.	S_1 order number 879P							
		3/32"	1/8"	5/32"	3/16"	1/4"	5/16"	3/8"	7/16"
3/32	.0938	C46520	-	-	-	-	-	-	-
.127	.1250	C46525	-	-	-	-	-	-	-
1/8	.1250	C46523	C46522	-	-	-	-	-	-
5/32	.1562	C46528	C46527	C46529	-	-	-	-	-
.157	.1570	C46531	-	-	-	-	-	-	-
.159	.1590	C46533	-	-	-	-	-	-	-
3/16	.1875	C46538	C46537	C46539	C46540	-	-	-	-
.191	.1910	C46545	C46544	-	C46546	-	-	-	-
13/64	.2031	-	C46547	-	-	-	-	-	-
7/32	.2188	C46549	C46548	C46550	C46551	-	-	-	-
1/4	.2500	C46554	C46553	C46555	C46556	C46557	-	-	-
.255	.2550	-	C46558	-	C46560	-	-	-	-
9/32	.2812	-	-	C46565	C46566	-	-	-	-
5/16	.3125	C46570	C46569	C46571	C46572	C46573	-	-	-
11/32	.3438	-	C46576	C46578	C46579	C46580	-	-	-
3/8	.3750	C46314	C46583	C46584	C46585	C46586	C46587	-	-
13/32	.4062	-	-	-	C46592	C46593	C46594	-	-
7/16	.4375	-	-	C46597	C46598	C46599	C46600	-	-
15/32	.4688	-	-	-	C46605	-	-	-	-
1/2	.5000	-	-	-	C46612	C46613	C46614	-	-
17/32	.5312	-	-	-	C46620	C46621	C46622	-	-
9/16	.5625	-	-	-	-	C46629	C46630	-	-
19/32	.5938	-	-	-	-	-	-	C46639	-
5/8	.6250	-	-	-	-	C46645	-	C46647	-
11/16	.6875	-	-	-	-	C46657	C46658	C46659	-
3/4	.7500	-	-	-	C46316	-	-	C46669	-
25/32	.7812	-	-	-	-	-	C46673	C46674	-
13/16	.8125	-	-	-	-	-	C46678	C46679	-
7/8	.8750	-	-	-	-	C46687	-	-	-
1	1.0000	-	-	-	-	-	-	-	-
1-1/16	1.0625	-	-	-	-	-	-	-	C46716
1-1/8	1.1250	-	-	-	-	-	-	C46723	-

Material Reference	Steel (HRC)				Stainless Steel			Cast Iron (HRC)		Aluminum and Non-Ferrous	Hi-Temp Alloy		Hardened Steel (HRC)
	Low Carbon		Alloy		Austenitic	Martensitic	PH	Gray	Nodular		Ni, Co, Fe Based Super Alloy	Titanium	
	Hardness	13-38	>38	16-38	> 38	300 Series	400 series		18-22	22-32			>45
Bright	☆		☆					☆	☆	☆			

☆ = Best Performance ◆ = Acceptable